

GENERAL WASTE FLAP RETROFIT INSTRUCTIONS

IMPORTANT NOTE:- ENSURE ALL RELEVANT PERSONNEL READ THESE INSTRUCTIONS PRIOR TO OPERATION

Kit Contents:

General Waste Flap x1
 Axle Rod x1
 Axle Clamp x2
 Spacer x2

Tools Required:

Screw Driver

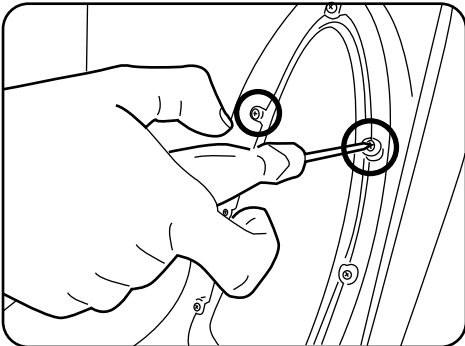

1. From inside of lid remove 2 off screws from the general waste aperture.

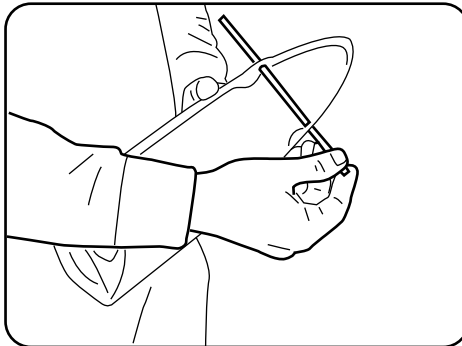

2. Place axle rod through holes in general waste flap.

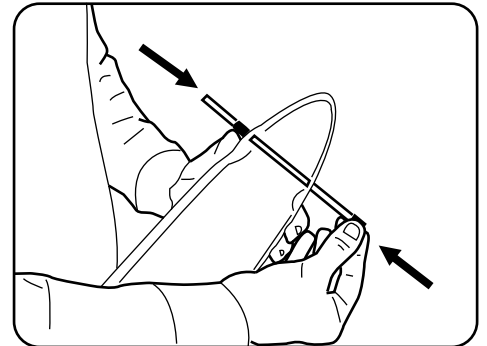

3. Place 1 off spacer on either end of the axle rod.

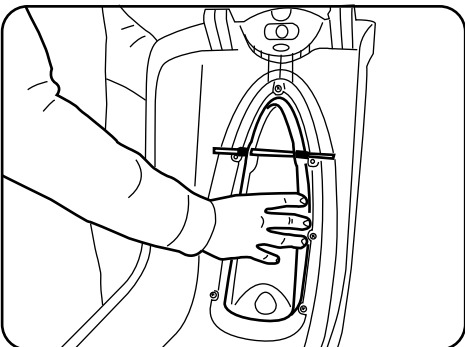

4. From the inside of the lid, line up the flap with the aperture so that the axle sits above the bosses.

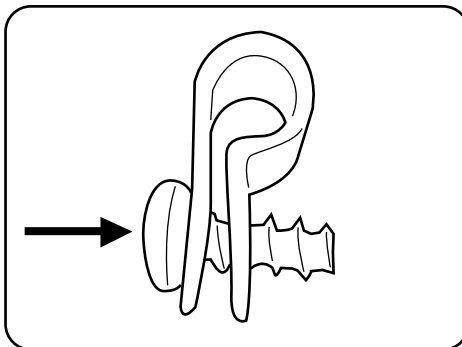

5. Place 2 off screws (removed from aperture) through the 2 off axles clamps.

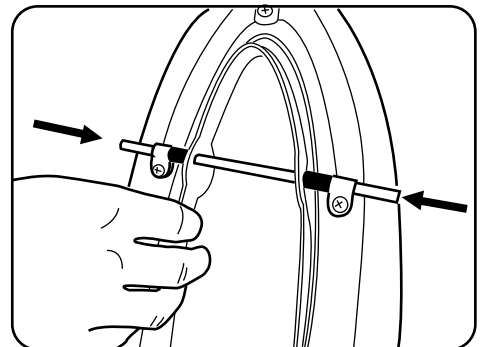

6. Place axle clamps over both ends of the axle rod.

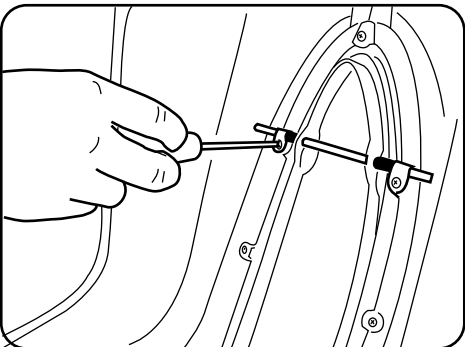

7. Using a screwdriver fix the screws into position.